

# T-10C PANEL

## WALL PANEL

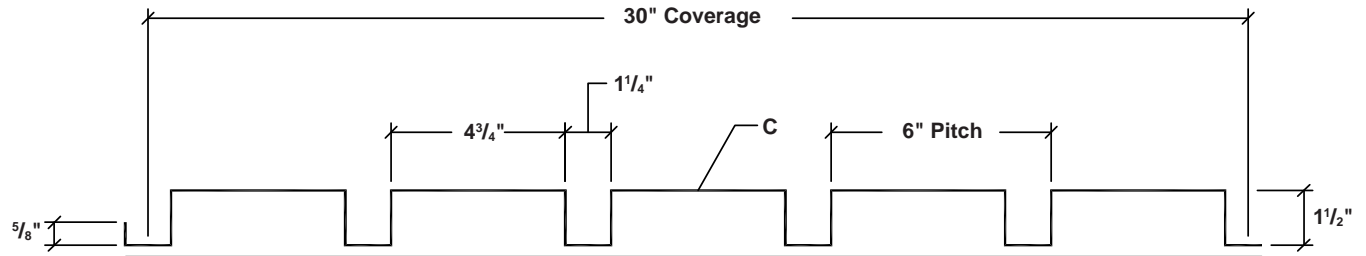

ARCHITECTURAL  
COMMERCIAL  
INDUSTRIAL  
PANEL

DIRECT FASTENED  
(EXPOSED)

30"  
COVERAGE

CUSTOM  
CAPABILITIES

OPEN FRAMING OR  
SOLID SUBSTRATE

## PANEL OVERVIEW

- ▶ Finishes: Kynar 500 (PVDF) standard, optional; multi-pass Kynar, Marblique, Plastisol, Polyester, and MS Colorfast45® (SMP)
- ▶ Gauges: 24ga, 22ga, 20ga, and 18ga
- ▶ 30" panel coverage, 1 1/2" rib height
- ▶ Crisp 90° vertical box ribs on 6" centers
- ▶ Optional material availability: Stainless Steel, Weathering Steel, Copper, and Aluminum
- ▶ Exposed fastened panel
- ▶ Custom capabilities include:
  - Crimp curving
  - Curving may be convex, concave, or "S" curves
  - Perforated panels for wind screens and liner panels

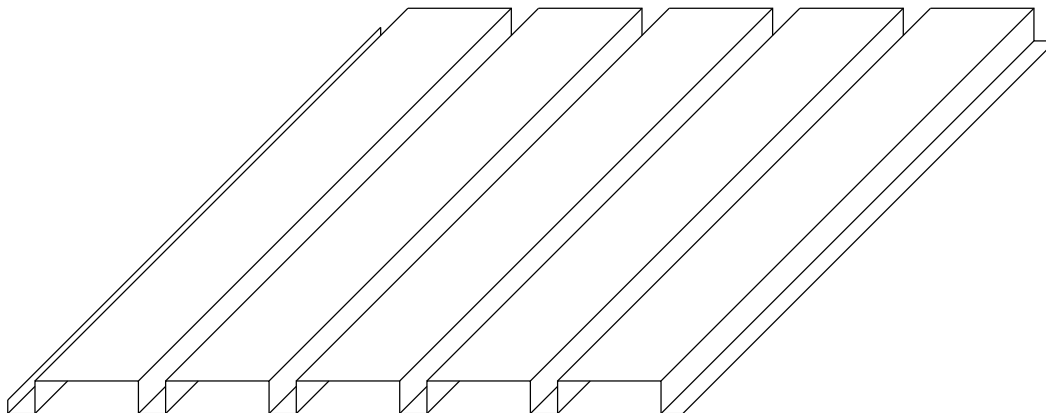

metal sales  
manufacturing corporation

MS

# T-10C PANEL

## ATTACHMENT DETAIL

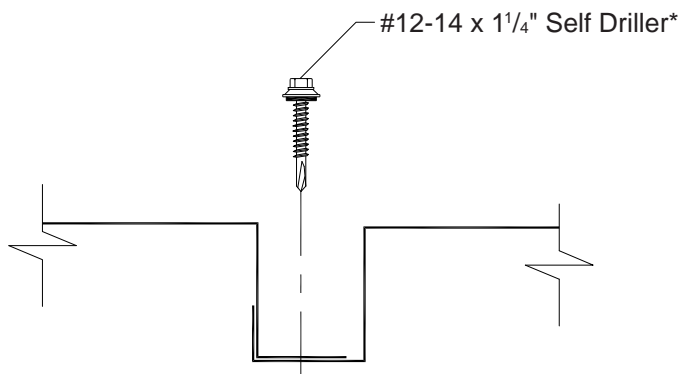

## FASTENING PATTERNS

### Fastening Pattern (Ends)

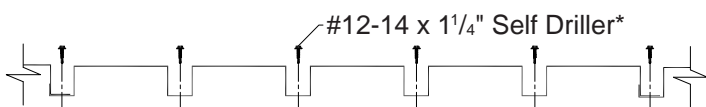

### Fastening Pattern (Field)

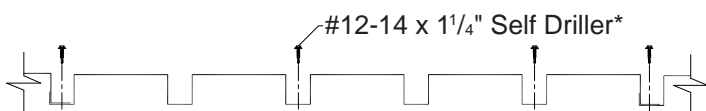

\*Note: #12-14 x 1" Self Driller is used for non-insulated applications.

## GENERAL INFORMATION

### ► Substructure

T-10C Panel is designed to be utilized over open structural framing, or a solid substrate.

### ► Coverage

T-10C Panels are available in a 1 1/2" depth with a 30" width coverage.

### ► Length

Minimum factory cut length is 5'-0".  
Maximum recommended panel length is 36'-0".

### ► Fasteners

The fastener selection guide should be consulted for choosing the proper fastener for specific applications. Quantity and type of fastener must meet necessary loading and code requirements.

*NOTE: All panels are subject to surface distortion due to improperly applied fasteners. Overdriven fasteners will cause stress and induce oil canning across the face of the panel at or near the point of attachment.*

### ► Availability

*Finishes:* Kynar 500 (PVDF) standard; optional: multi-pass Kynar, Marblique, Plastisol, Polyester, and MS Colorfast45® (SMP)  
*Gauges:* 24ga, 22ga, 20ga, and 18ga

## SECTION PROPERTIES

## ALLOWABLE UNIFORM LIVE LOADS PSF (3 or More Equal Spans)

Ga.	Width (in.)	Yield KSI	Weight PSF	Top in Compression		Bottom in Compression		Inward (Gravity / Deflection) Load						Outward Uplift (Stress) Load					
				Ixx In <sup>4</sup> /ft	Sxx In <sup>3</sup> /ft	Ixx In <sup>4</sup> /ft	Sxx In <sup>3</sup> /ft	5'	6'	7'	8'	10'	12'	5'	6'	7'	8'	10'	12'
24	30"	50	1.48	0.1300	0.1217	0.0876	0.1100	101	71	52	40	21	12	149	104	77	59	38	26
22	30"	50	1.91	0.1812	0.1723	0.1248	0.620	149	104	77	58	30	17	211	147	108	83	53	37
20	30"	33	2.27	0.2240	0.2164	0.1700	0.2048	124	87	64	49	31	22	175	122	90	69	44	31
18	30"	33	2.96	0.3000	0.2876	0.2600	0.2784	169	118	87	66	43	30	232	162	119	92	59	41

- Theoretical section properties have been calculated per AISI 2001 "Specification for the Design of Cold-formed Steel Structural Members." Ixx and Sxx are effective section properties for deflection and bending.
- Allowable load is calculated in accordance with AISI 2001 specifications considering bending, shear, combined bending and shear, deflection. Allowable load considers the worst case of 3 and 4 equal span conditions. Allowable load does not address web crippling, fasteners/support connection, or panel disengagement. Panel weight is not considered.
- Deflection consideration is limited by a maximum deflection ratio of L/180 of span.
- Allowable loads do not include a 1/3 stress increase.

**metal sales**  
manufacturing corporation



Kent, WA (800) 431-3470  
Temple, TX (800) 543-4415  
Longmont, CO (800) 289-7663  
Antioch, TN (800) 251-8508  
Woodland, CA (800) 759-6019  
Rogers, MN (800) 328-9316  
Spokane, WA (800) 572-6565

Jefferson, OH (800) 321-5833  
Rock Island, IL (800) 747-1206  
Sellersburg, IN (800) 999-7777  
Jacksonville, FL (800) 394-4419  
Orwigsburg, PA (800) 544-2577  
Independence, MO (800) 747-0012  
Fontana, CA (800) 782-7953

Anchorage, AK (866) 640-7663  
Bay City, MI (888) 777-7640  
Detroit Lakes, MN (888) 594-1394  
Mocksville, NC (800) 228-6119