



Seam-Loc 24 on 16 ga Purlins

Roof Fastener Spacing (feet)

Wind Speed (mph)
Exposure Category

100D

110D

120D

130D

140D

150D

160D

170D

Roof Slope: 0.5:12 to 1.47:12

Thickness	zone 1'	zone 1	zone 2	zone 3
24 ga	5.00	5.00	5.00	5.00

Thickness	zone 1'	zone 1	zone 2	zone 3
24 ga	5.00	5.00	5.00	4.67

Thickness	zone 1'	zone 1	zone 2	zone 3
24 ga	5.00	5.00	5.00	4.00

Thickness	zone 1'	zone 1	zone 2	zone 3
24 ga	5.00	5.00	4.33	3.33

Thickness	zone 1'	zone 1	zone 2	zone 3
24 ga	5.00	5.00	4.00	2.33

Thickness	zone 1'	zone 1	zone 2	zone 3
24 ga	5.00	4.33	3.33	2.67*

Thickness	zone 1'	zone 1	zone 2	zone 3
24 ga	4.67	4.00	2.67	2.33*

Thickness	zone 1'	zone 1	zone 2	zone 3
24 ga	N.G.	N.G.	N.G.	N.G.

Roof Slope: 1.47:12 to 6.11:12

zone 1,2e	z 2n,2r,3e	zone 3r
5.00	5.00	5.00

zone 1,2e	z 2n,2r,3e	zone 3r
4.67	5.00	4.00

zone 1,2e	z 2n,2r,3e	zone 3r
4.00	4.00	3.33

zone 1,2e	z 2n,2r,3e	zone 3r
3.33	3.33	2.67

zone 1,2e	z 2n,2r,3e	zone 3r
2.67	2.67	2.67*

zone 1,2e	z 2n,2r,3e	zone 3r
4.00*	2.67*	2.33*

zone 1,2e	z 2n,2r,3e	zone 3r
N.G.	N.G.	N.G.

zone 1,2e	z 2n,2r,3e	zone 3r
N.G.	N.G.	N.G.

Roof Slope: 6.11:12 to 12:12

z 1,2e,2r	z 2n,3r	zone 3e
5.00	5.00	5.00

z 1,2e,2r	z 2n,3r	zone 3e
5.00	5.00	4.67

z 1,2e,2r	z 2n,3r	zone 3e
4.33	5.00	4.00

z 1,2e,2r	z 2n,3r	zone 3e
3.67	5.00	3.33

z 1,2e,2r	z 2n,3r	zone 3e
3.00	4.33	2.33

z 1,2e,2r	z 2n,3r	zone 3e
2.33	3.67	2.67*

z 1,2e,2r	z 2n,3r	zone 3e
3.67*	3.33	2.33*

z 1,2e,2r	z 2n,3r	zone 3e
N.G.	N.G.	N.G.

Notes:

1. Allowable spacing is based on a Design Pressures listed in the FBC 2020 Approval, FL10999.8, .9 and determined by linear of those values. 1/3 increase is not included for wind. The fasteners and fastening patterns are shown in the Approval.
2. Allowable spacing is based on an applied load determined using ASCE 7-16 for the Wind Speeds, Wind Exposure Categories, "Roof Slopes, and Roof Zones shown, assuming 10 square feet of tributary area, Enclosed Gable Roof, 3 or more span case, Topographic Factor of 1, and Mean Roof Height of 25 feet.
3. Allowable spacing is determined for wind suction using the pressures shown, resulting from the combination $0.6DL + 0.6W$. Also considered is the inward wind pressure, 20 psf live load and the weight of the panel.

* - Indicates that S-5! Clamps are required at clip locations.

#N/A

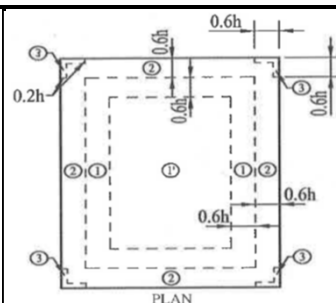

Roof Slope: 0.5:12 to 1.47:12

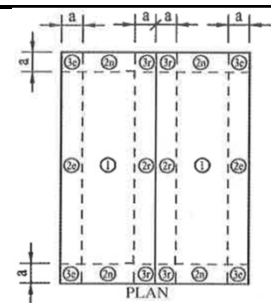

Roof Slope: 1.47:12 to 12:12