



16" Magna-Loc on 19/32" Plywood

Roof Fastener Spacing (feet)

Wind Speed (mph)
Exposure Category
120D

Roof Slope: 0.5:12 to 1.47:12				
Thickness	zone 1'	zone 1	zone 2	zone 3
24 ga	2.50	2.50	2.50	2.50

Roof Slope: 1.47:12 to 6.11:12		
zone 1,2e	z 2n,2r,3e	zone 3r
2.50	2.50	2.50

Roof Slope: 6.11:12 to 12:12		
z 1,2e,2r	z 2n,3r	zone 3e
2.50	2.50	2.50

130D

Thickness	zone 1'	zone 1	zone 2	zone 3
24 ga	2.50	2.50	2.50	2.50

zone 1,2e	z 2n,2r,3e	zone 3r
2.50	2.50	2.50

z 1,2e,2r	z 2n,3r	zone 3e
2.50	2.50	2.50

140D

Thickness	zone 1'	zone 1	zone 2	zone 3
24 ga	2.50	2.50	2.50	2.25

zone 1,2e	z 2n,2r,3e	zone 3r
2.50	2.50	1.50

z 1,2e,2r	z 2n,3r	zone 3e
2.50	2.50	2.25

150D

Thickness	zone 1'	zone 1	zone 2	zone 3
24 ga	2.50	2.50	2.50	1.25

zone 1,2e	z 2n,2r,3e	zone 3r
2.50	1.75	1.00*

z 1,2e,2r	z 2n,3r	zone 3e
2.50	2.50	1.25

160D

Thickness	zone 1'	zone 1	zone 2	zone 3
24 ga	2.50	2.50	2.50	1.00*

zone 1,2e	z 2n,2r,3e	zone 3r
2.50	0.75	1.00*

z 1,2e,2r	z 2n,3r	zone 3e
2.50	2.50	1.00*

170D

Thickness	zone 1'	zone 1	zone 2	zone 3
24 ga	2.50	2.50	1.75	1.00*

zone 1,2e	z 2n,2r,3e	zone 3r
2.50	1.00*	1.00*

z 1,2e,2r	z 2n,3r	zone 3e
2.50	2.50	1.00*

180D

Thickness	zone 1'	zone 1	zone 2	zone 3
24 ga	2.50	2.50	1.00	1.00*

zone 1,2e	z 2n,2r,3e	zone 3r
N.G.	N.G.	N.G.

z 1,2e,2r	z 2n,3r	zone 3e
2.50	1.75	1.00*

190D

Thickness	zone 1'	zone 1	zone 2	zone 3
24 ga	N.G.	N.G.	N.G.	N.G.

zone 1,2e	z 2n,2r,3e	zone 3r
N.G.	N.G.	N.G.

z 1,2e,2r	z 2n,3r	zone 3e
N.G.	N.G.	N.G.

Notes:

1. Allowable spacing is based on a Design Pressures listed in the FBC 2020 Approval, FL11560.6 and determined by linear interpolation of those values. 1/3 increase is not included for wind. The fasteners and fastening patterns are shown in the Approval.

2. Allowable spacing is based on an applied load determined using ASCE 7-16 for the Wind Speeds, Wind Exposure Categories, "Roof Slopes, and Roof Zones shown, assuming 10 square feet of tributary area, Enclosed Gable Roof, 3 or more span case, Topographic Factor of 1, and Mean Roof Height of 25 feet.

3. Allowable spacing is determined for wind suction using the pressures shown, resulting from the combination $0.6DL + 0.6W$. Also considered is the inward wind pressure, 20 psf live load and the weight of the panel.

* - Indicates that MPW-1203-8 Clip are required in this zone.

#N/A

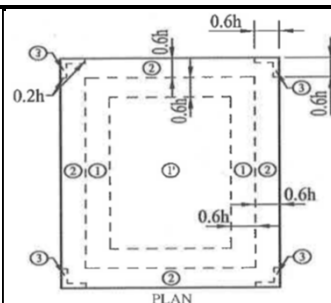

Roof Slope: 0.5:12 to 1.47:12

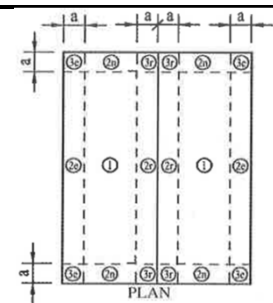

Roof Slope: 1.47:12 to 12:12