

**EVALUATION REPORT OF  
METAL SALES MANUFACTURING CORPORATION  
'24 GA. SOFFIT PANEL'**

**FLORIDA BUILDING CODE 8TH EDITION (2023)  
FLORIDA PRODUCT APPROVAL  
FL 9482.5-R7  
PANEL WALLS  
SIDING**

**Prepared For:  
Metal Sales Manufacturing Corporation  
7800 Highway 60  
Sellersburg, IN 47172  
Telephone: (502) 855-4300  
Fax: (502) 855-4200**

**Prepared By:  
Bala Sockalingam, Ph.D., P.E.  
Florida Professional Engineer #62240  
1216 N Lansing Ave., Suite C  
Tulsa, OK 74106  
Telephone: (918) 492-5992**

**This report consists of  
Evaluation Report (2 Pages including cover)  
Installation Details (1 Page)  
Load Span Table (1 Page)**

**Report No. C2671-5  
Date: 7.22.2023**

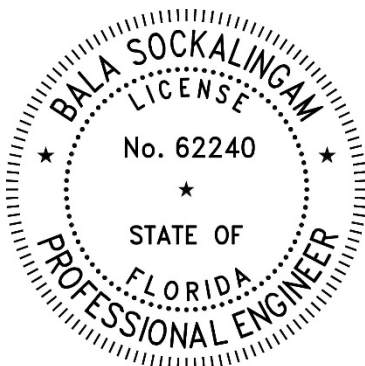

This item has been digitally signed and sealed by Bala Sockalingam, PE, on the date indicated.

Printed copies of this document are not considered signed and sealed and this signature must be verified on any electronic copies.

Manufacturer: Metal Sales Manufacturing Corporation

Product Name: Soffit Panel

Panel Description: 12" wide coverage with 1" high ribs

Materials: Min. 24 ga. 50 ksi steel. Galvanized coated steel (ASTM A653) or Galvalume coated steel (ASTM A792) or painted steel (ASTM A755) as per FBC 2023 Section 1405.2. Pre-painted panels are required for use with adhesive.

Support Description: Min. 16 ga., min 50 ksi steel section. (Must be designed by others)

Design Pressure:  $\pm 55$  psf @ support spacing of 48" o.c. (@ 3 span condition)

Panel Attachment:  
At panel sidelap #10-16 x 1" long pancake head corrosion resistant self-drilling screws

Sidelap Adhesive: Geocel 4600™ Structural Adhesive Sealant (1/4" bead)

Test Standards: Wall assembly tested in accordance with ASTM E330-02 'Standard Test Method for Structural Performance of Exterior Windows, Doors, Skylights and Curtain Walls by Uniform Static Air Pressure Difference.'

Test Equivalency: The test procedure in ASTM E330-02 complies with test procedure prescribed in ASTM E330-14.

Code Compliance: The product described herein has demonstrated compliance with FBC 2023 Section 1404.5.

Product Limitations: Design wind loads shall be determined for each project in accordance with FBC 2023 Section 1609 or ASCE 7-22 using allowable stress design. The maximum support spacing listed herein shall not be exceeded. The design pressure for reduced support spacing may be computed using rational analysis prepared by a Florida Professional Engineer or based on Metal Sales load span table. This evaluation report is not applicable in High Velocity Hurricane Zone.

Supporting Documents: ASTM E330 Test Report  
ENCON Technology Inc.  
C1524-1, Reporting Date 8/24/2007

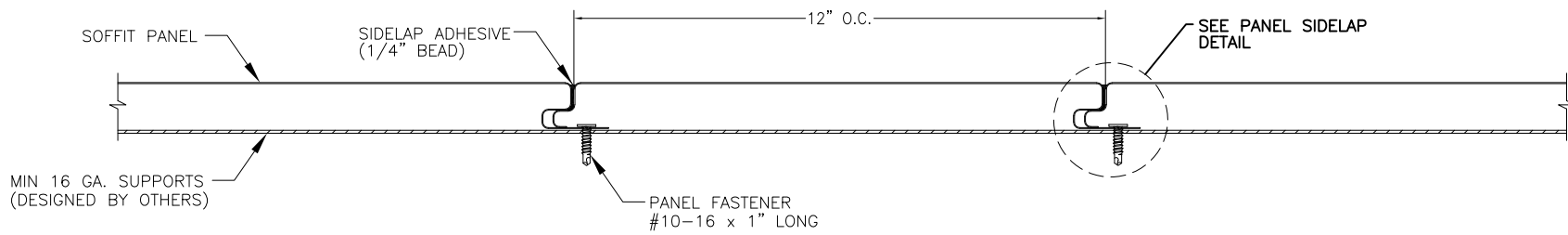

TYPICAL PANEL INSTALLATION X-SECTION

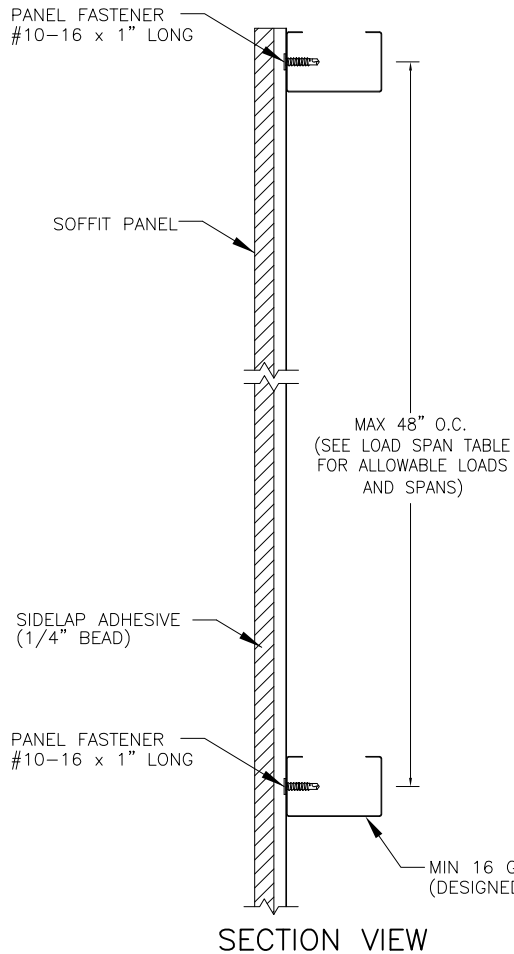

SECTION VIEW

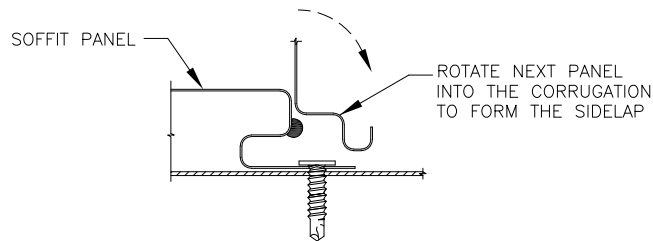
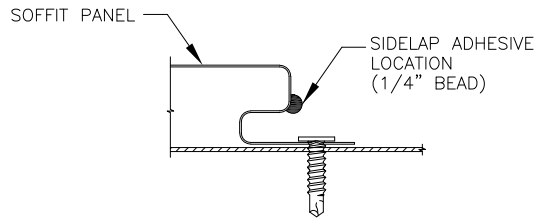

PANEL INSTALLATION

**GENERAL NOTES:**

1. WALL PANEL HAS BEEN DESIGNED IN ACCORDANCE WITH THE FLORIDA BUILDING CODE (FBC).
2. WALL PANELS SHALL BE MIN. 24 GA. (t = 0.022"). EFFECTIVE COVERING WIDTH OF PANEL = 12".
3. THE WALL PANELS SHALL BE INSTALLED OVER STRUCTURE AS SPECIFIED ON THIS DRAWING.
4. REQUIRED DESIGN WIND LOADS SHALL BE DETERMINED FOR EACH PROJECT. THIS PANEL SYSTEM MAY NOT BE INSTALLED WHEN THE REQUIRED DESIGN WIND LOADS ARE GREATER THAN THE ALLOWABLE DESIGN LOADS.
5. ALL FASTENERS MUST BE IN ACCORDANCE WITH THIS DRAWING & THE FLORIDA BUILDING CODE. IF A DIFFERENCE OCCURS BETWEEN THE MINIMUM REQUIREMENTS OF THIS DRAWING & THE CODE, THE CODE SHALL CONTROL.
6. SUPPORTS MUST BE DESIGNED TO WITHSTAND WIND LOADS AS REQUIRED REQUIRED FOR EACH APPLICATION AND ARE THE RESPONSIBILITY OF OTHERS.
7. PANELS MAY SPAN BETWEEN BOTTOM AND TOP SUPPORTS (WALL APPLICATION WITH PANELS ORIENTED VERTICALLY), SIDE TO SIDE BETWEEN CORNER SUPPORTS (WALL APPLICATION WITH PANELS ORIENTED HORIZONTALLY) OR UNDER ROOF (SOFFIT APPLICATION WITH PAINTED SURFACE FACING DOWNWARD).

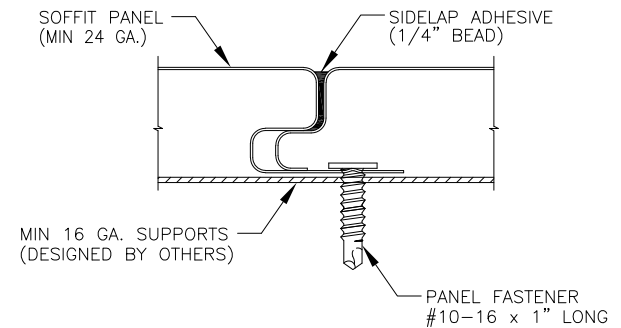

PANEL SIDELAP

DRAWN BY: B.S.		CHECKED BY: D.S.	
PLOT: DATE: 7/14/2023			
NO.	REVISION	DESCRIPTION	DATE
DRAWING TITLE: SOFFIT PANEL			
CONSULTANTS		MANUFACTURER	
BALA SOCKALINGAM, PH.D., P.E.		METAL SALES MANUFACTURING CORP.	
1216 N LANSING AVE, SUITE C		7800 HIGHWAY 60	
TULSA, OK 74106		SELLERSBURG, IN 47172	
PHONE: 918-492-5992		FAX: 866-366-1543	
DRAWING NO. 2671-5		REV.	
SHEET NO. 1		OF 1	

# METAL SALES MANUFACTURING CORPORATION

## SOFFIT PANEL

12" wide, 24 ga. (min) Steel Panel

Span Condition	Loading Type	Allowable Load (psf)								
		Support Spacing (ft)								
		2.00	2.25	2.50	2.75	3.00	3.25	3.50	3.75	4.00
Two Span	Positive or Negative	96.8	86.0	77.4	70.4	64.5	59.6	55.3	50.1	44.0
Three Span	Positive or Negative	110.0	97.8	88.0	80.0	73.3	67.7	62.9	58.7	55.0
Four or More Spans	Positive or Negative	105.9	94.1	84.7	77.0	70.6	65.1	60.5	56.5	51.4

### Notes:

1. Allowable load for each condition is the smallest load calculated based on fastener capacity, panel strength and deflection limit of L/120. Allowable loads are calculated for minimum 24 ga. panel.
2. The panel allowable properties are determined from full scale ASTM E330 test at 4' 0" span
3. The panel fasteners are #10-16 x 1" long self drilling fasteners located at panel sidelap.
4. Sidelap adhesive is Geocel 4600™ Structural Adhesive Sealant. Min 1/4" bead field applied.
5. Steel supports are minimum 16 ga.. All supports must be designed to resist all loads imposed on the panel.
6. Panels must be installed as per Evaluation Report FL 9482.5 and Metal Sales current installation procedure.